

PANEL 'A'													
TYPE: S/D N000					(2 SECTIONS)								
MFG: FLUSH MOUNTED					CU BKG/END. BUS (NEMA 3R)								
MNF: 2P-200A M.C.B.					VOLTS: 120/240V, 1ϕ, 3W								
					BUS: 200C								
					LOAD: (SEE LOAD ANALYSIS)								
LOAD	COND.	WIRE	TRIP	POLE	DESCRIPTION	CRT No.	CRT No.	DESCRIPTION	POLE	TRIP	WIRE	COND.	LOAD
10000	1"	6	60	2	AHU #1 (**)	1	2		2	50	6	1"	5904
12000	1"	6	50	2	RANGE	5	6	WATER HEATER	2	30	10	3/4"	4500
1400	1/2"	12	20	1	REFRIGERATOR	9	10	SMALL APPLIANCES	1	20	12	1/2"	1500
1000					DISHWASHER	11	12	SMALL APPLIANCES					1500
800					GARAGE DISPOSAL	13	14	HOOD/FAN LIGHT					1500
1500					WASHER	15	16	LAUNDRY REC					1500
5000	3/4"	10	30	2	DRYER	17	18	BATH REC					(*)
					GEN. LITS & RECS	19	20	BATH REC					(*)
					GEN. LITS & RECS	21	22	GEN. LITS & RECS					(*)
						23	24						(*)
						25	26						(*)
						27	28	EXTERIOR RECS					(*)
						29	30	SPACE					(*)
						31	32						(*)
						33	34						(*)
						35	36						(*)
						37	38						(*)
						39	40						(*)
						41	42						(*)

- (*) PART OF THE 3W/SQ.FT. LOAD
- (*) PROVIDE AFCI TYPE BREAKER
- (**) COOLING & HEATING LOADS ARE NON-CONCURRENT-PROVIDE HIGHER TYPE BREAKER.

LOAD ANALYSIS	
1712 SQ.FT X 3W/SQ.FT	5,136 VA
BASED ON 120/240V, 1ϕ, 3W	32,250 VA
R172 SQ.FT EXCEPT A/C	37,356 VA
1ST 100VA @ 100%	10,000 VA
27,336 @ 40%	10,934 VA
A/C 65% HEAT	6,500 VA
	27,434 W/240V = 114.3 A

- NOTES: (NOT ALL NOTES ARE APPLICABLE)**
- PROVIDE ALL FINAL CONNECTIONS TO ALL EQUIPMENT AND APPLIANCES.
 - PROVIDE ALL A/C CONTROL AS REQUIRED BY A/C DRAWINGS OR MANUFACTURER DIAGRAMS.
 - ALL LAUNDRIES AND KITCHEN RECEPTACLES SHALL BE GFI TYPE.
 - TERMINAL RECEPTACLES TO BE GFI AND WEATHER PROOF.
 - COORDINATE LOCATION OF ALL DISCONNECT SWITCHES WITH OTHER TRADES TO ALLOW N.E.C. REQUIREMENT CLEARANCE.
 - CIRCUITS WIRING REQUIRED TO BE AS FOLLOWS: 120V-2 WIRE (L-N); 120/240V - 3 WIRE (L1-N1) 240V-2 WIRE (L1). WHEN EQUIPMENT GROUND IS REQUIRED INCREASE CONDUIT SIZE AS REQUIRED.
 - ALL WIRING TO BE COPPER.
 - COORDINATE LOCATION OF AIR CONDITIONERS (INDOOR UNIT) DISCONNECT SWITCH WITH A/C MANUFACTURER TO KEEP N.E.C. REQUIRED CLEARANCE.
 - MINIMUM WIRE SIZE SHALL BE #12 WITH THE EXCEPTION OF 15A GENERAL LTC. AND RECEPTACLE BRANCH CIRCUITS WHICH ARE #14
 - CONDUIT IN UNFINISHED AREAS SHALL BE EXPOSED.
 - FUSES SHALL BE DUAL ELEMENT TIME DELAY TYPE.
 - INSTALL NICKEL PHIL STRIP IN ALL EMPTY CONDUITS FOR FUTURE USE.
 - ALL MATERIALS SHALL BE ILL. APPROVED.
 - WORKMANSHIP SHALL BE TO BEST COMMERCIAL PRACTICE.
 - INSTALLATION SHALL BE IN ACCORDANCE WITH LOCAL, STATE AND NATIONAL CODES.
 - RECESSED LIGHT FIXTURES OVER BATHTUB OR SHOWER SHALL BE COMPLETELY ENCLOSED AND VAPOR PROOF-SUITABLE FOR WET LOCATIONS.
 - ALL LUMINAIRES SHALL BE PROPERLY SUPPORTED IN ACCORDANCE WITH THE CEILING SYSTEM MANUFACTURER RECOMMENDATIONS AND LOCAL CODE REQUIREMENTS.
 - ISSUES ARE DIAGNOSTIC ONLY. THEY DO NOT SHOW EVERY BRND REQUIRED FOR THE INSTALLATION.
 - THIS DRAWING IS A GUIDE FOR THE INSTALLATION OF ELECTRICAL SERVICE. THE ELECTRICAL CONTRACTOR IS RESPONSIBLE TO PROVIDE A FUNCTIONING SYSTEM.
 - A/C EQUIPMENT WIRING, BREAKER AND FUSE SIZES ARE BASED ON A/C EQUIPMENT SPECIFIED ON CONTRACT DRAWINGS. CONTRACTOR IS RESPONSIBLE FOR PROVIDING ALL WIRING, BREAKER AND FUSE SIZES IN ACCORDANCE WITH A/C EQUIPMENT MANUFACTURER REQUIREMENTS IF DIFFERENT FROM THAT SPECIFIED ON DRAWINGS, AS WELL AS ANY FEEDER CHANGES BEING AFFECTED BY THIS CHANGE. CONTRACTOR SHALL MAKE ABOVE MENTIONED CHANGES AT NO EXTRA COST.
 - CONTRACTOR SHALL COORDINATE ALL HIS WORK WITH OTHER TRADES IN ORDER TO ENSURE AND INSTALL ALL CONTROL WIRING AND BACKWASH. ALL POWER CONTROL CIRCUITS WIRING AND BACKWASH AS SHOWN ON THE AIR CONDITIONING DRAWINGS OR SPECIFICATIONS. IF AIR CONDITIONING DRAWINGS REFER TO MANUFACTURER'S WIRING DIAGRAMS, THE CONTRACTOR SHALL COORDINATE WITH SAID MANUFACTURER ALL REQUIREMENTS AND INCLUDE ALL RELATED WORK IN HIS CONTRACT.
 - ALL DEVICES, PANELS, OUTLETS, SWITCHES, ETC. TO BE MOUNTED ABOVE FLOOD CRITERIA.
 - ALL 15 AND 20 AMP, 120 VOLT RECEPTACLES OUTLETS MUST BE LISTED TAMPER RESISTANT PER NEC240.4 (400.11)
 - CONTRACTOR MAY USE ROWEY FOR BRANCH CIRCUITS AS AN ALTERNATE.

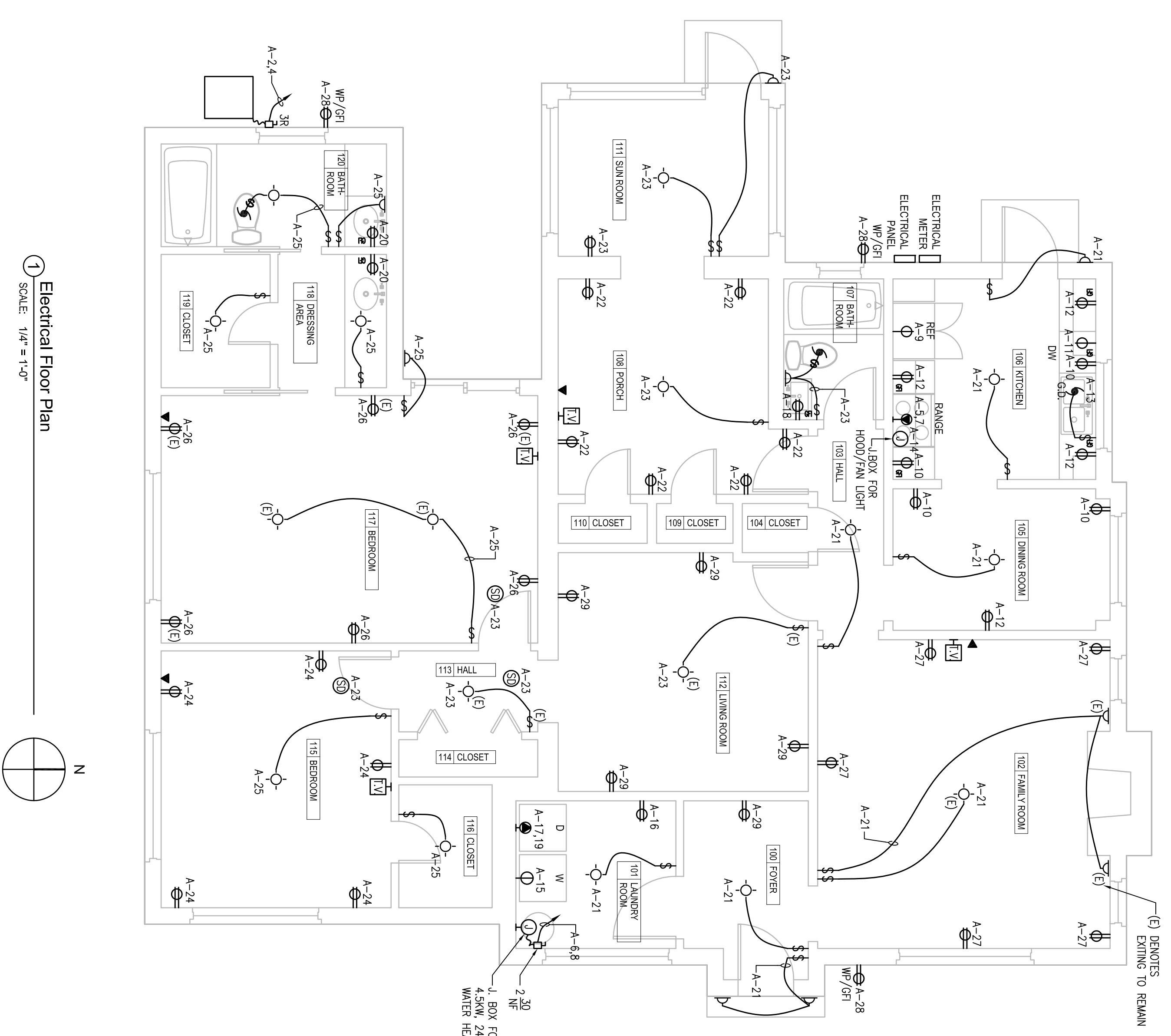

1 Electrical Floor Plan
SCALE: 1/4" = 1'-0"

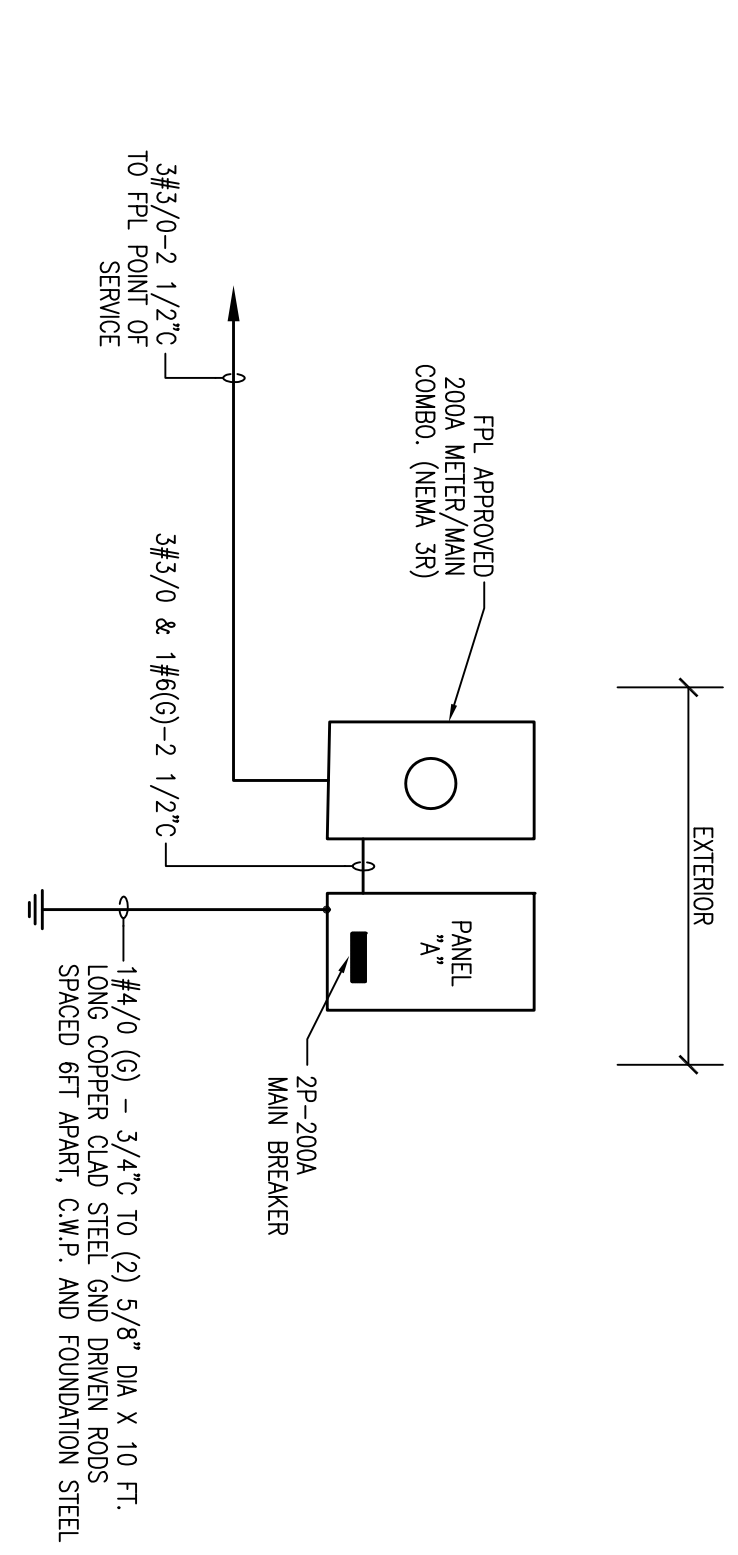
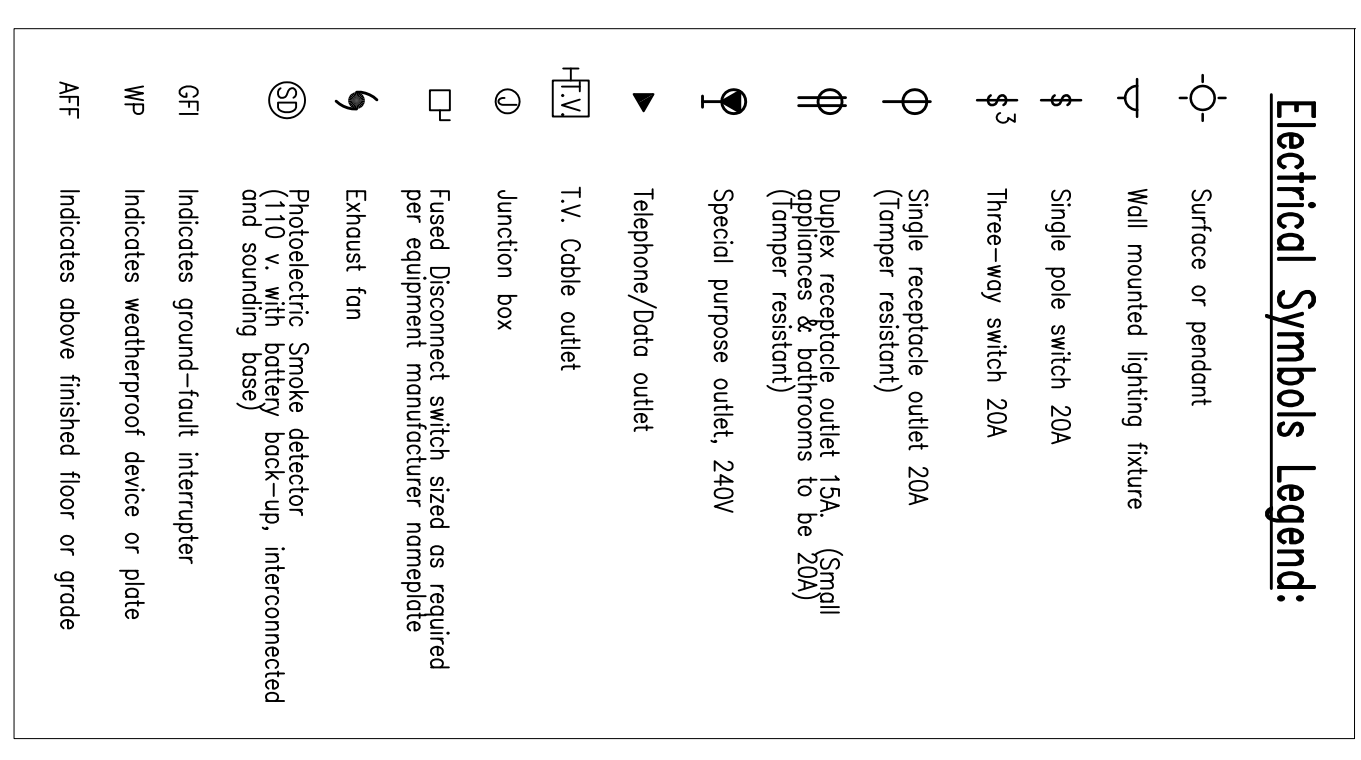

JMM Consulting Engineers LLC
Certificate of Authorization #9892
Jose M. Martinez, P.E. #66018
8353 SW 124 St, Suite 108
Miami, Florida 33156
TEL: (305) 255-1621
FAX: (305) 255-1732

EXISTING RESIDENCE RENOVATION		JMM CONSULTING ENGINEERS, LLC.	
1120 CORDOVA ST CORAL GABLES, FLORIDA 33134		JOSE M MARTINEZ (PE 56018)	
8353 SW 124 STREET, SUITE 108 MIAMI, FL. 33156 TEL. 305- 255 1621		8353 SW 124 ST, SUITE 108 MIAMI, FLORIDA 33156 TEL. (305) 255-1621 FAX (305) 255-1732	
DATE	09/25/09	JOB NO.	
DESIGN		PROJECT	